

(1) SMR Code	(2) Federal Stock Number	(3) Description	(4) Unit of Meas.	(5) Qty	(6) 15-day Maintenance In Unit	(7) Organizational alw Illustration	(a) Figure No.	(b) Item No.	
Reference number & mfg. code			Usable on code	(a)	(b)	(c)	(d)		
				1-5	6-20	21-50	51-100		
GROUP 10-FRONT AXLE									
1000-FRONT AXLE ASSEMBLY									
PAOZZ	5315-752-1651	PIN, SHOULDER, HEADLESS: AXLE HOUSING 7521651(19207)	A	EA	6	*	*	99	1
PAOZZ	4730-954-1281	PLUG, PIPE: 1/4-18NPT, FRONT AXLE HOUSING MS490005-4(96906)	A	EA	2	*	*	99	2
PAOZZ	5330-839-9066	GASKET, ANNULAR: FILLER PLUG MS35769-21(96906)	A	EA	2	*	*	99	3
PAOZZ	4730-968-6129	PLUG, PIPE, MAGNETIC: 3/4-1/4 NPT MS490006-10(96906)	A	EA	1	*	*	99	4
PAOZZ	5365-732-6126	PLUG, MACHINE THREAD: 7326126(19207)	A	EA	1	*	*	99	5
1004-STEERING MECHANISM									
PAOZZ	2520-734-6991	FLANGE ASSEMBLY, DRIVE: 7346991(19207)	A	EA	2	*	*	100	1
PAOZZ	5340-734-6992	PLUG, EX: DRIVE FLANGE 7346992(19207)	A	EA	1	*	*	100	2
PAOZZ	5330-054-6865	PACKING, PREFORMED: 220984, (44674)	A	EA	1	*	*	100	3
PAOZZ	5306-752-1631	BOLT, MACHINE: FLANGE TO HUB 7521631 (19207)	A	EA	10	*	*	100	4
PAOZZ	5310-584-5272	WASHER, LOCK: FLANGE TO HUB MS35338-48(96906)	A	EA	10	*	*	100	5
XAOZZ		FLANGE, DRIVE: 8758278(19207)	A		1			100	6
PAOZZ	2530-734-6993	GASKET: DRIVE FLANGE 7346993(19207)	A	EA	2	*	*	100	7
PAOZZ	2520-740-9550	SEAL, PLAIN, ENCASED: HUB BEARING, INNER FRONT 7409550(19207)	A	EA	2	*	*	100	8
PAOZZ	2520-740-9551	DEFLECTOR, DIRT AND MOISTURE: FRONT WHEEL BRAKE DRUMS 7409551(19207)	A	EA	2	*	*	100	9
PAOZZ	2530-734-6982	SPINDLE: WHEEL BEARINGS, W/BEARING 7346982(19207)	A	EA	2	*	*	100	10
PAOZZ	4730-050-4208	FITTING: STEERING KNUCKLE PLATE MS15003-1(96906)	A	EA	2	*	*	100	11
PAOZZ	5310-616-6354	WASHER, FLAT: SPINDLE STUD MS35335-38(96906)	A	EA	10	*	*	100	12
PAOZZ	5310-012-1983	NUT, PLAIN, HEXAGON: SPINDLE STUD 121983(21450)	A	EA	10	*	*	100	13

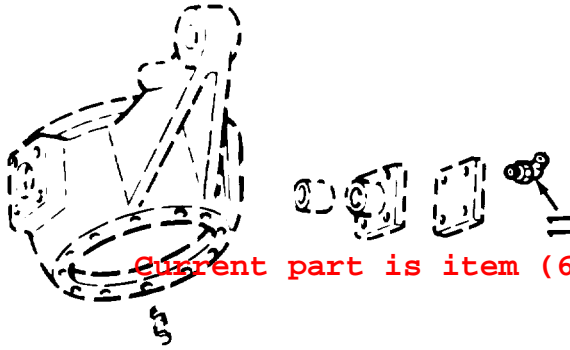

TA 009263

Current part is item (6) on diagram. Available at www.oshkoshequip.com

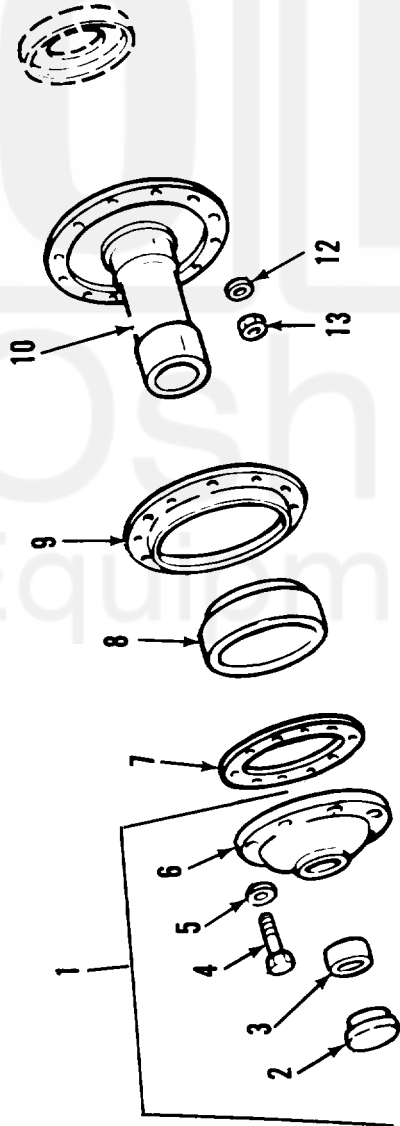
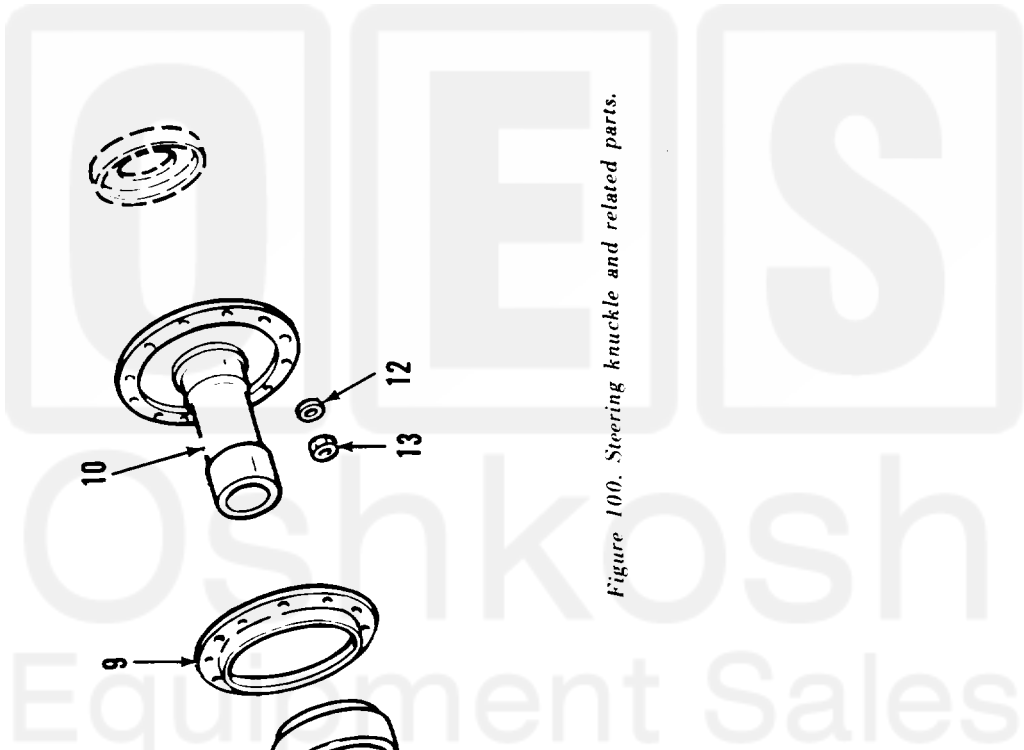

Figure 100. Steering knuckle and related parts.



Current part is item (6) on diagram. Available at www.oshkoshequip.com